

Bestmed Medical Scheme Session

Website and App Navigation
Session

08 June 2022



Bestmed Member App



Bestmed mobile app

Step 1:

Visit the app store on your phone and search for the “Bestmed” app

Step 2:

Download and install

Step 3:

Register if you are a new user

Step 4:

Log in if you have already created an account

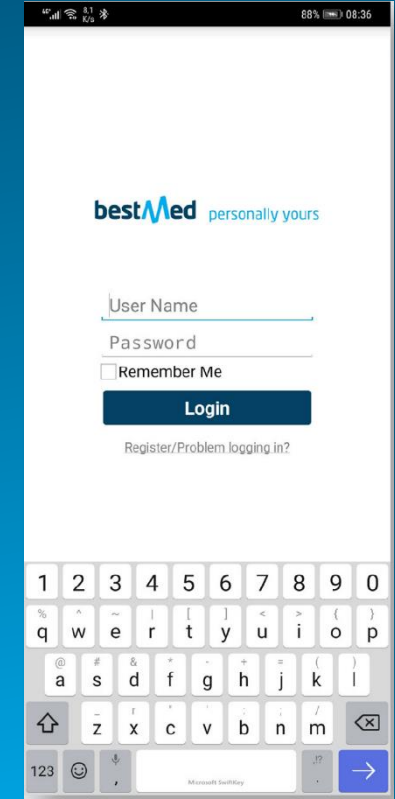
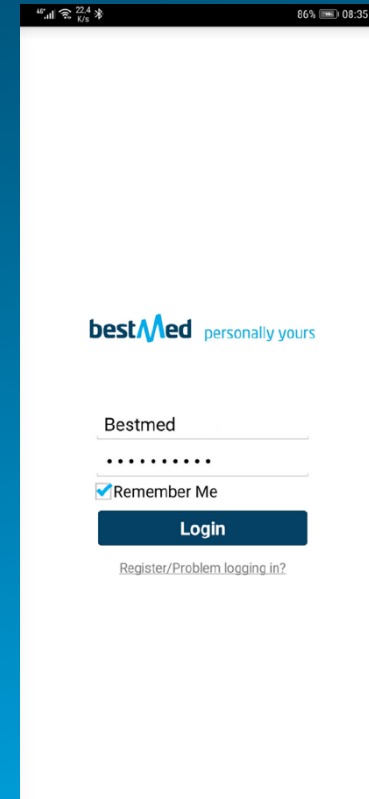
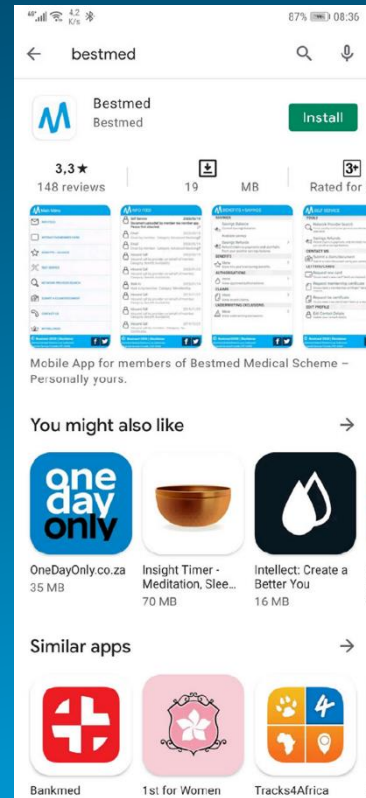

How to register on our app

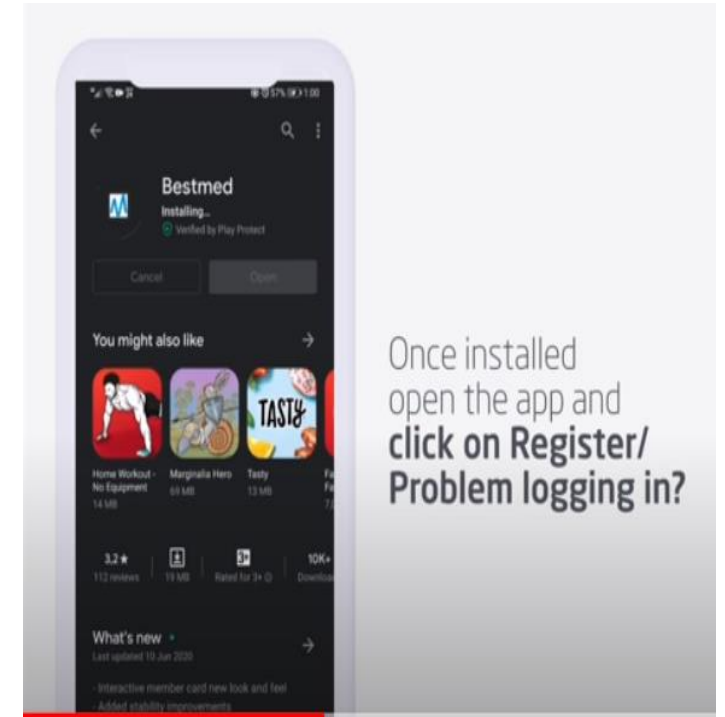
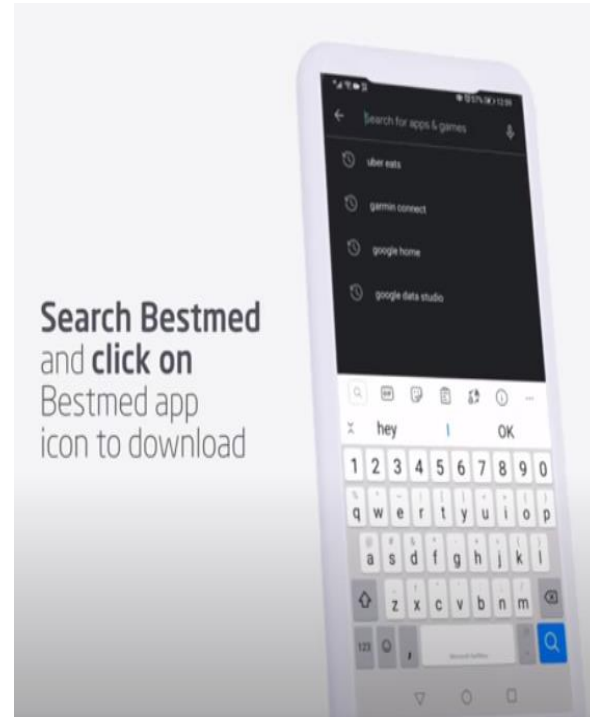

How to register on our app continued...

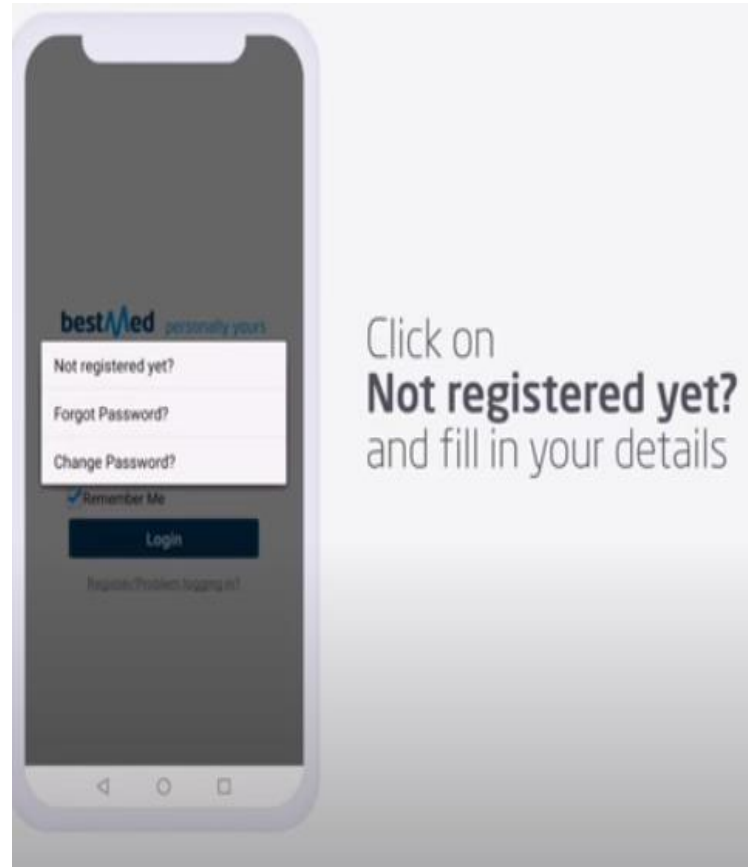
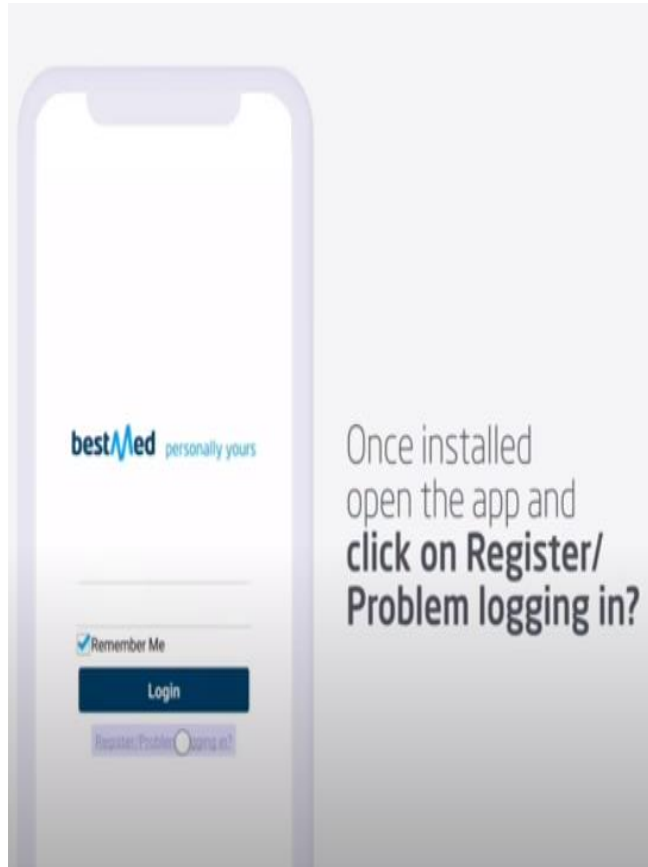

How to register on our app continued...

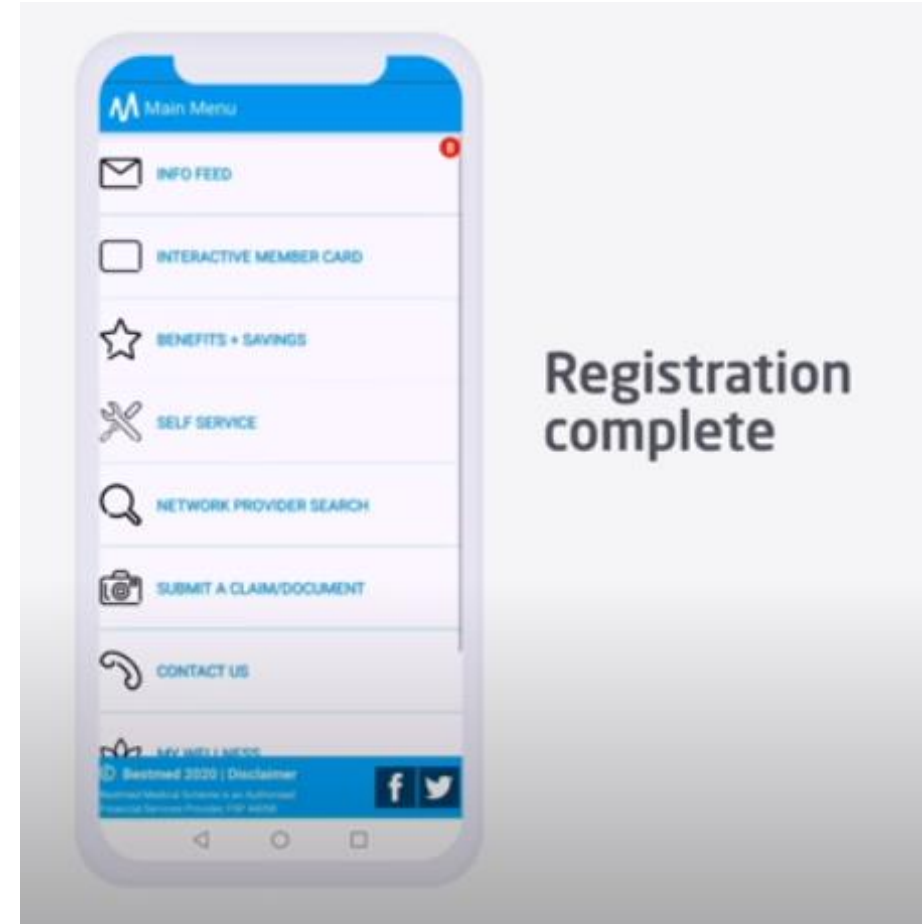
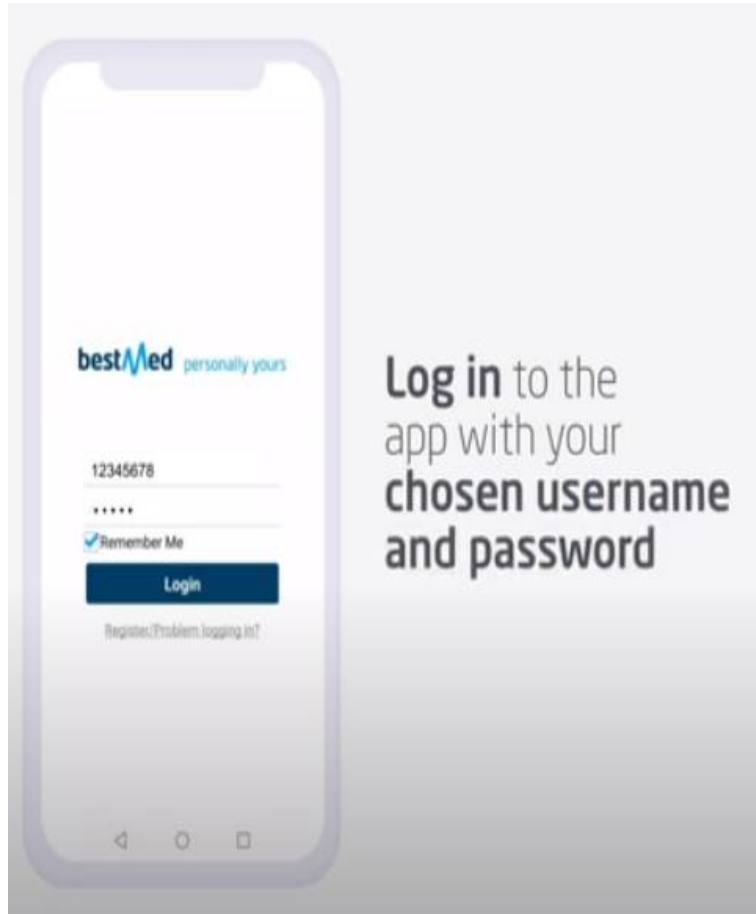

Bestmed mobile app continued...

Login Screen

- Users can register a new profile
- Change password
- Request new password when it has been forgotten

Main Menu Screen

- Once the user has successfully logged in, they will view the main menu that consists of 9 features
 - Info Feed
 - Interactive Member Card
 - Benefits + Savings
 - Self service
 - Network Provider Search
 - Submit a claim/document
 - Contact Us
 - My Wellness
 - Profile

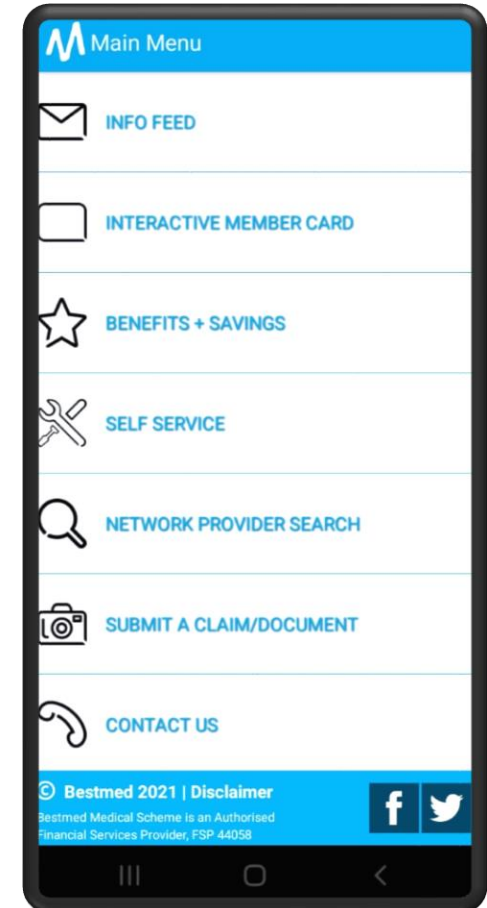
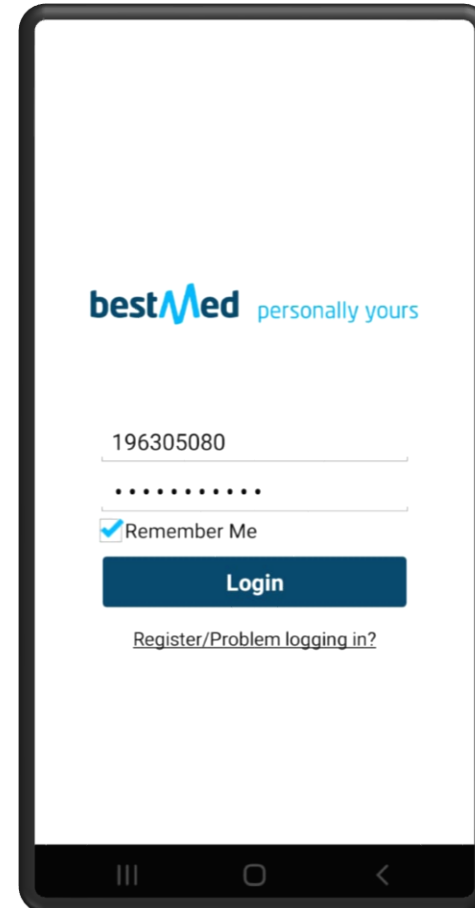

Bestmed mobile app continued...

Info Feed

- Consists of all documents requested through self service , including campaigns and emails sent by Bestmed

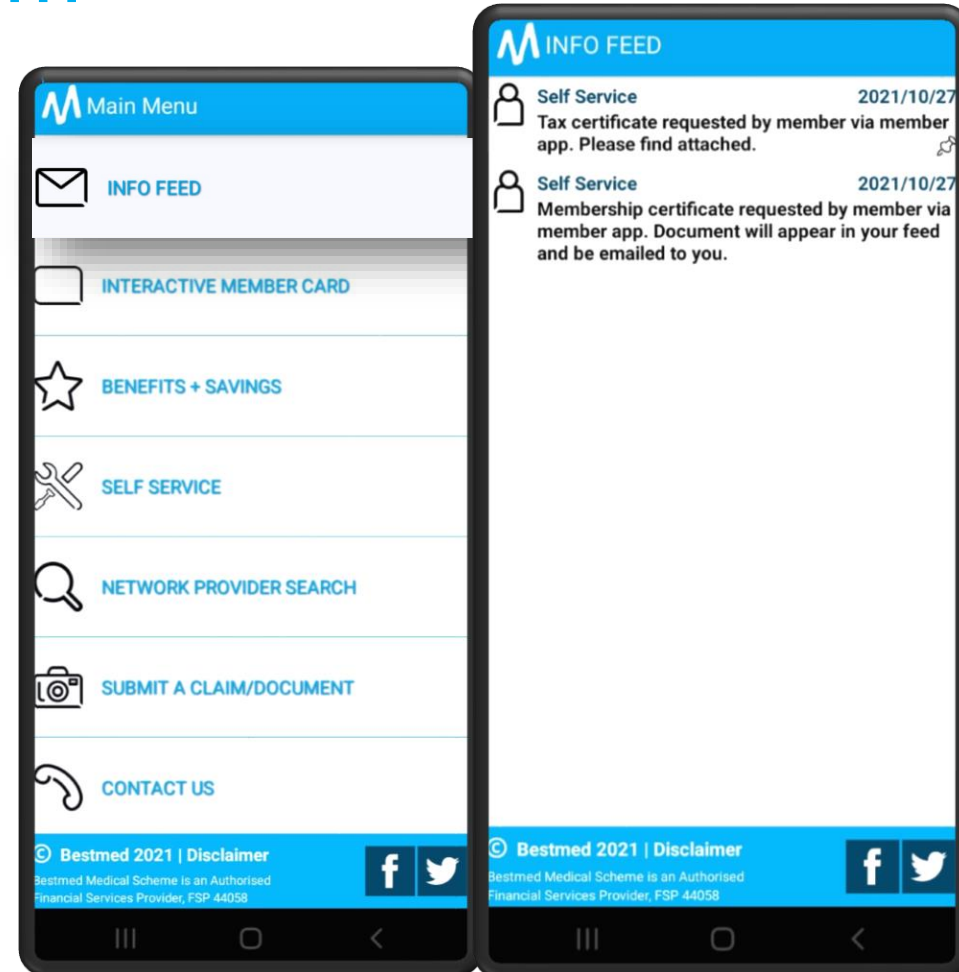

Bestmed mobile app continued...

Interactive Member Card

- Member's interactive card with membership details
- Members can share the card to Email, WhatsApp and other platforms

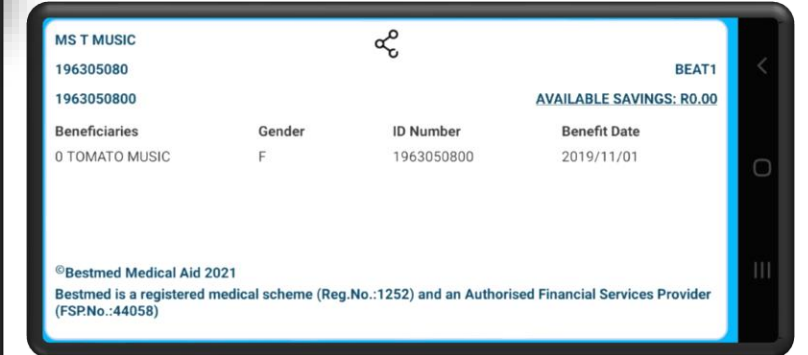
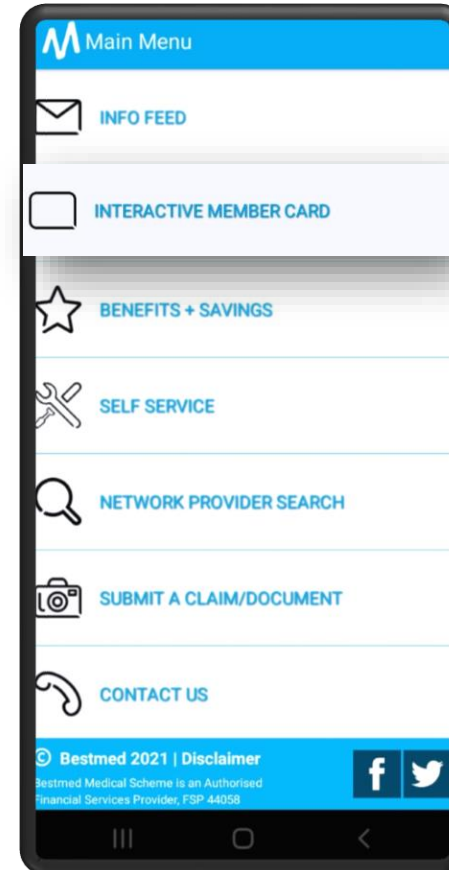

Bestmed mobile app continued...

Benefits + Savings

- Consists of member's benefits and savings

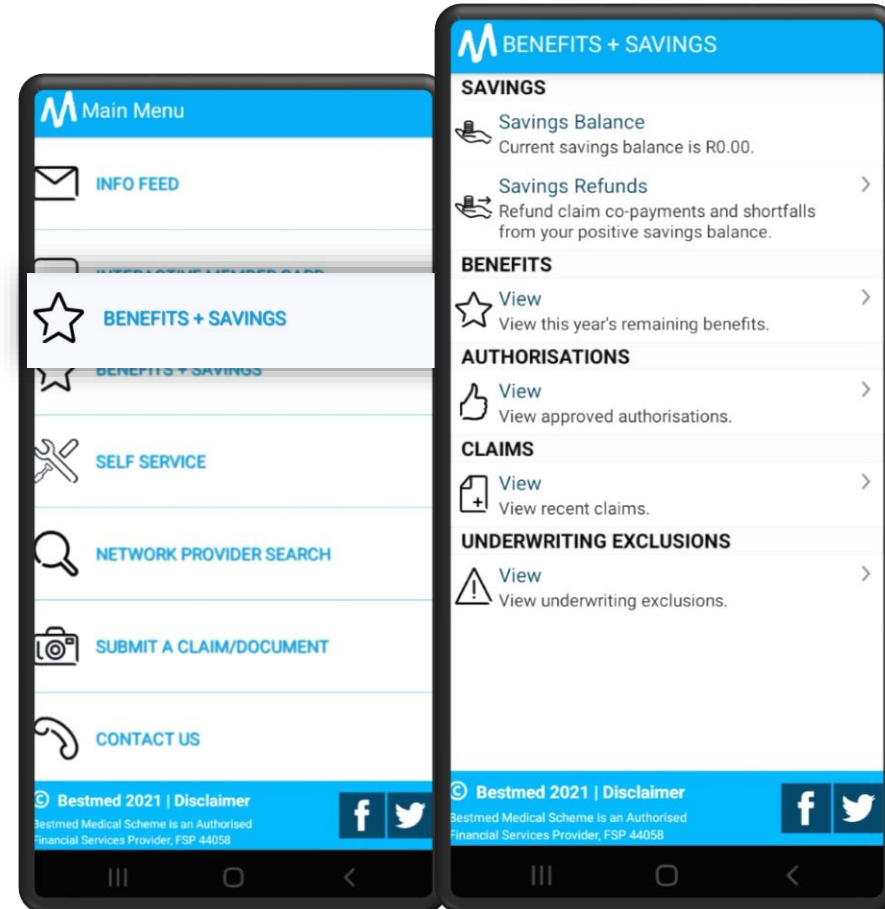

Bestmed mobile app continued...

Self Service

- Members self service tool



Bestmed mobile app continued...

Network Provider Search

- Searching for a network provider

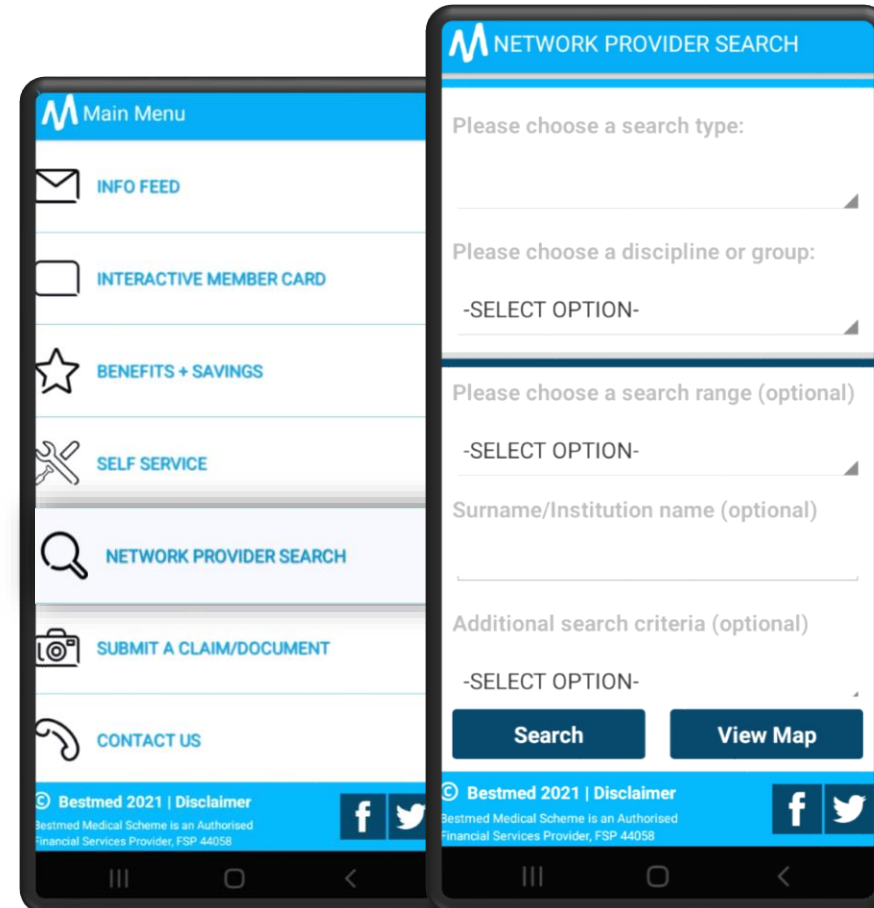

Bestmed mobile app continued...

Submit a Claim/Document

- Submitting a claim

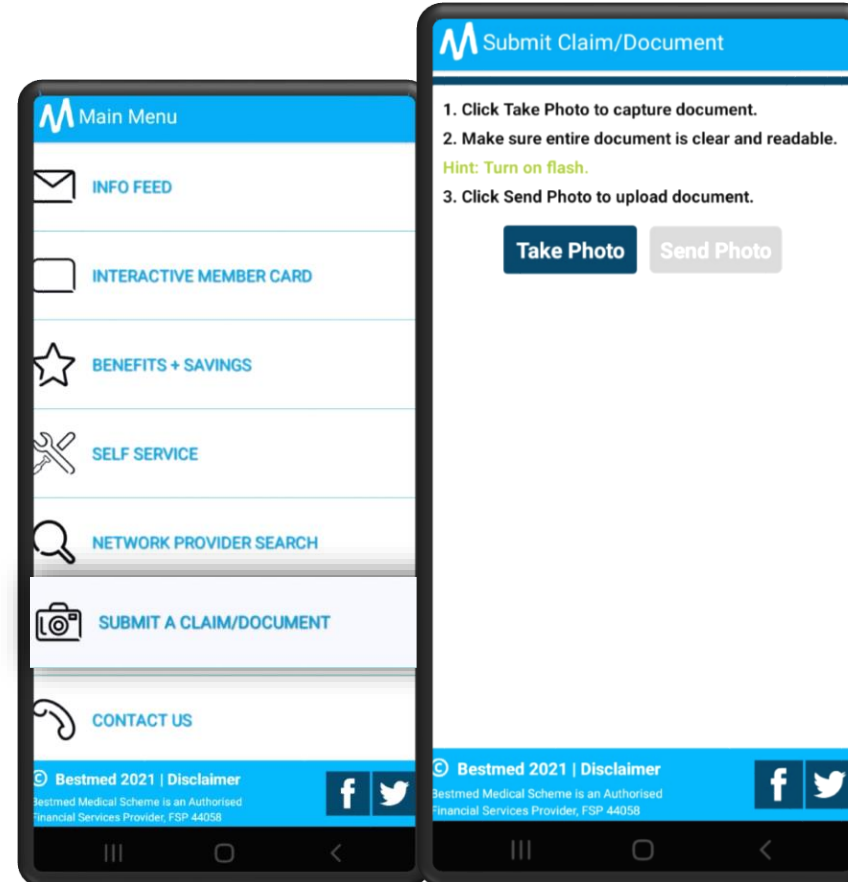

Bestmed mobile app continued...

Contact Us

- Bestmed's contact details

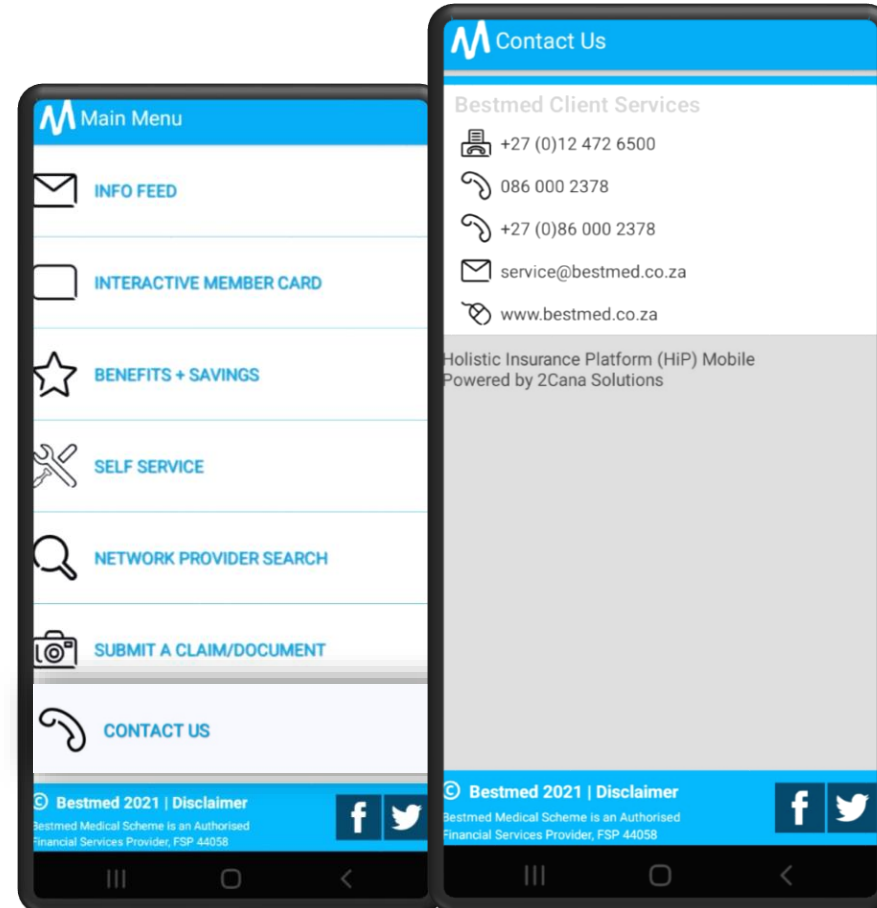

Bestmed mobile app continued...

My Wellness

- Member's wellness assessments
- Able to view the biometrics from the Health Assessment Report
- Able to access history and available assessments.

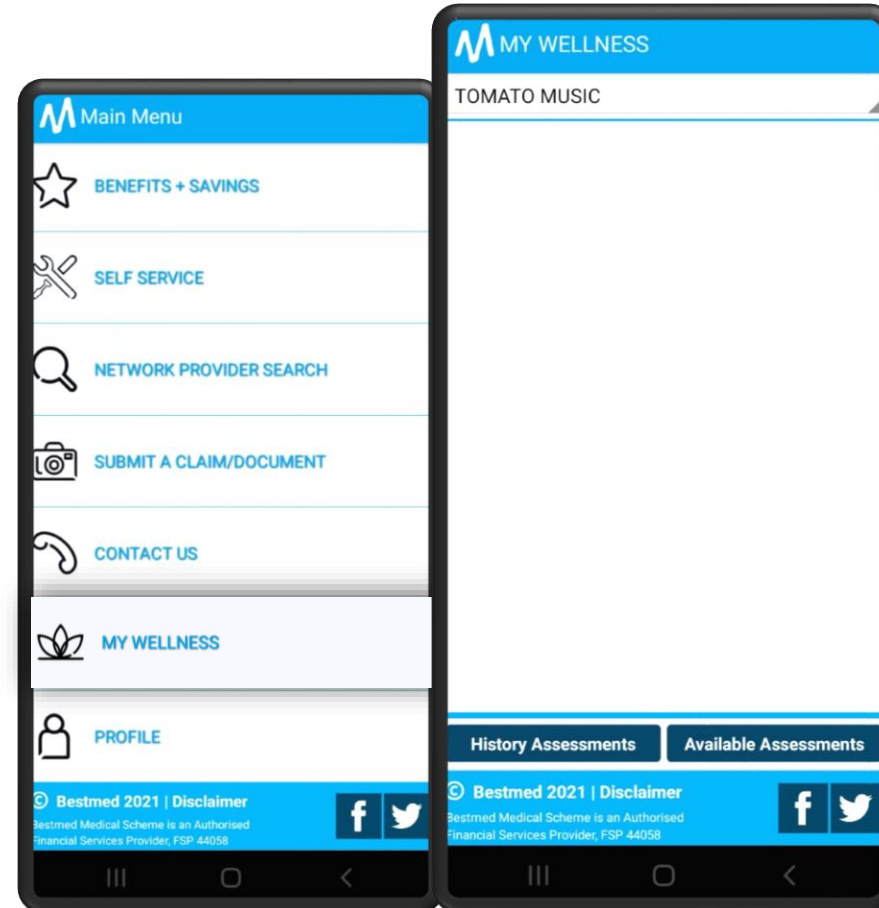

Bestmed mobile app continued...

Profile

- The member can view information which includes:

1. Policy information
2. Personal details
3. Contact details (including email and address) – The member has access to edit only contact details
4. Banking details

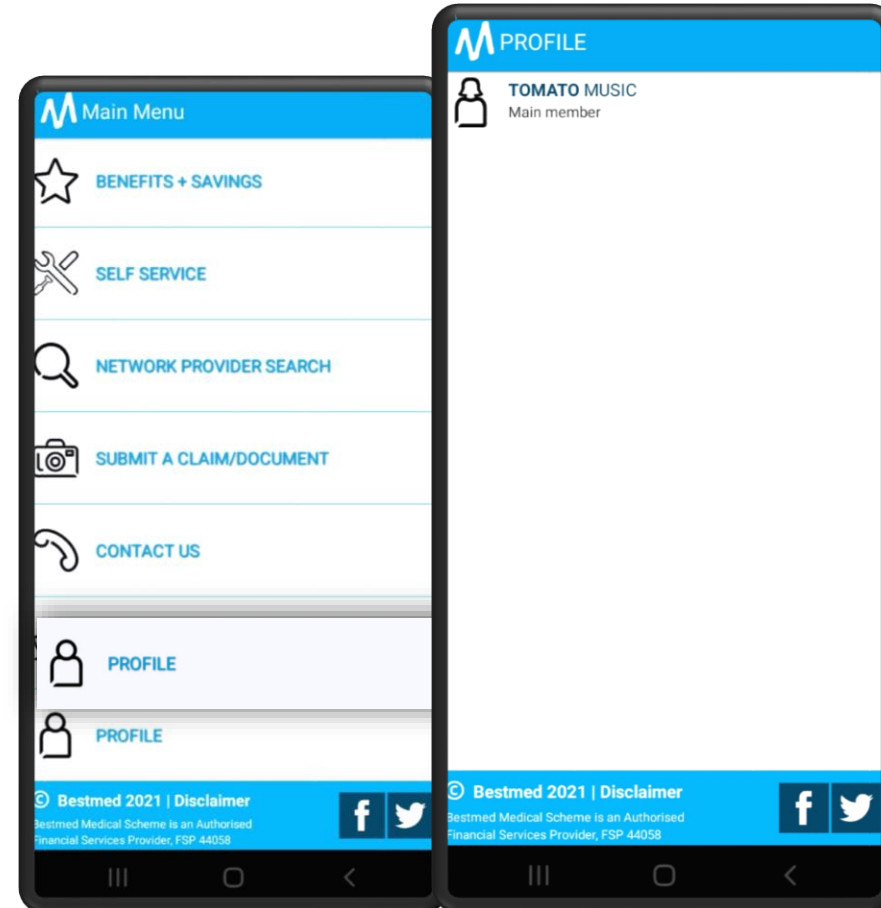



Questions

Thank you!

